



Sensor Urinal Flush Valve ELG-400

➤ **Description:**

Conceal Sensor Urinal Flush Valve, For Back/Top Spud Urinals.

Top Spud Model: ELG-400-TS
Back Spud Model: ELG-400-BS

➤ **Flow Value**

Adjustable flow value:

➤ **Specifications:**

Zinc Plate With Stainless steel Center Cover; Chrome Plated With Bushing Center Cover Sensor Urinal Flush Valve with the following features:

- Two-Tone Plate
- Standard Parts; Beautiful and easy to operate and maintain
- Separate control stop for turning off water supply for maintenance
- Inlet/outlet pipe diameter and thread: G1/2"
- Working Pressure: 7-100psi
- Standard pre-set sensor range(14"-20" for Kodak gray card)
- Adjustable sensor range(5"-36.5" for Kodak gray card)
- Filter included
- Pre-flush option: pre-flush duration is around 2 second; the second flush duration is around 8 second.
- 24 hour sentinel flush
- 6volt DC battery supply or 6volt DC transformer supply(Must be ordered separately)
- (4) AAA size Alkaline batteries included
- Necessary kits included.

➤ **Accessory (need to order separately)**

€ 6Volt DC Transformer

See SLOAN catalog for more SLOAN products.

The product is in conformance with standard CJ/T 194-2004



SLOAN®

Sloan Valve Water Technologies (Suzhou) Co., Ltd.
16 Huo Ju Road, Suzhou New District, 215011
Tel: 0512-68438068 Fax: 0512-68434622

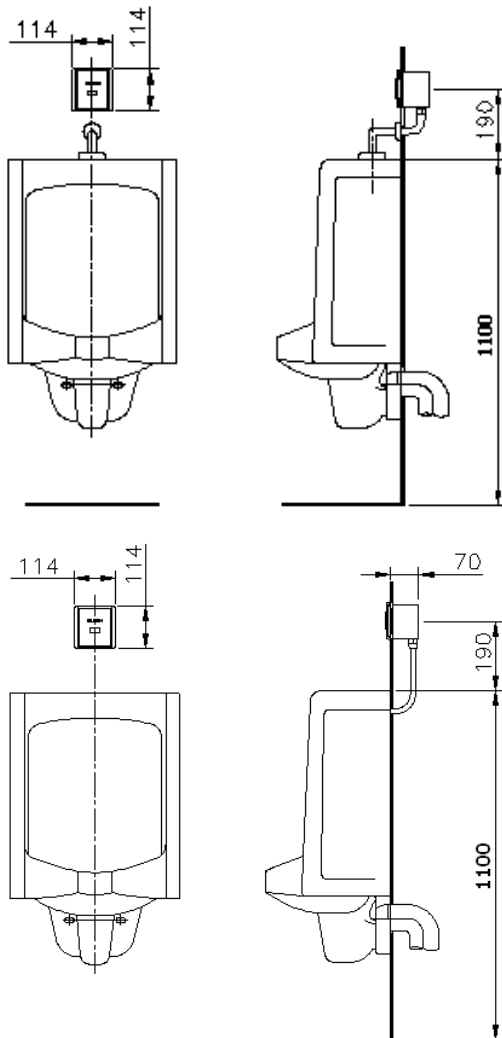

Unit: mm

The information contained in this document is subject to change without notice.

<http://www.sloan.com.cn>